



BOUNDARIES AND BARRIERS MANAGING THE INTERTIDAL ZONE

CUSTOMS HOUSE, SYDNEY
TUESDAY 14 AUGUST 2012

BOUNDARIES AND BARRIERS MANAGING THE INTERTIDAL ZONE

Tuesday 14 August 2012

THE BARNET LONG ROOM, CUSTOMS HOUSE, LEVEL 1, 31 ALBERT ST, CIRCULAR QUAY, SYDNEY

The subject of management in the intertidal zone is an ongoing issue and concern for many coastal and estuarine Councils. In Lands below the High Water Mark (HWM) Councils contend with the myriad of management responsibilities, regulations, competing interests and user conflicts. These issues require ongoing attention to ensure effective, efficient and sustainable management.

Local Councils typically manage the use, access, safety and environmental matters in these areas. They undertake numerous tasks such as:

- managing access and tourism
- regulating development
- conserving environmental and cultural values
- monitoring the use of marine park zones (intertidal protected areas, marine sanctuaries, aquatic reserves etc.)
- managing risks
- undertaking internal and community education and deliver outreach activities and programs
- monitoring the safety of beach users and providing lifesaving services
- the facilitation of events

The SCCG forum seeks to provide clarification on the roles and responsibilities of Local Government in the foreshore; the plethora of legislation that applies to this zone; the challenges present in roles of enforcement; strategies in improving Council relationships with communities and user groups and expectations of Council under fisheries legislation. This forum will cover a broad range of issues with presentations from leading experts and practitioners in the field.

This SCCG forum will also present case studies from their Member Councils to address the main issues that they must contend with in the management of foreshores. The forum will provide workshops to initiate collaboration on ways in which Local Government can improve the situation by:

- building partnerships across other management agencies
- using education as an outreach tool to user groups
- identifying ways in which empowerment can be delivered to their compliance and enforcement Officers

The SCCG Boundaries and Barriers: Managing the intertidal Zone forum will provide a significant hub of information and will equip individuals from our Member Councils with the knowledge and clarification of their role in the intertidal zone.

BOUNDARIES AND BARRIERS MANAGING THE INTERTIDAL ZONE

Tuesday 14 August 2012

THE BARNET LONG ROOM, CUSTOMS HOUSE, LEVEL 1, 31 ALBERT ST, CIRCULAR QUAY, SYDNEY

0900 REGISTRATIONS OPEN

0930 INTRODUCTION & WELCOME

Mr Geoff Withycombe SCCG Executive Officer

0945 A LOCAL GOVERNMENT PERSPECTIVE

Ms Sue Hartley Senior Assessment Officer, Division of Local Government

1010 CROWN LAND MANAGEMENT

Mr Stephen Fenn Manager of Stakeholder Relations, Crown Lands South
Crown Lands, Department of Primary Industries

1035 THE ROLE OF ENFORCEMENT: CHALLENGES AND OPPORTUNITIES

Mr Carlos Da Rocha Senior Ranger, Waverley Council

1100 MORNING TEA

1130 WORKING AND ENGAGING WITH COMMUNITY GROUPS

Dr Judy Lambert AM Director, Community Solutions

1155 FISHERIES LEGISLATION & MANAGEMENT IN THE INTERTIDAL ZONE: IMPLICATIONS FOR COUNCILS

Mr Chris Clarke Supervising Fisheries Officer Sydney North Department of Primary Industries,
NSW Fisheries

1220 ADDRESSING THE ISSUES OF SHARED BOUNDARIES

Mr Gary Dunnett National Parks & Wildlife Services

1245 LUNCH

1330 CASE STUDIES ON HOW TO ENGAGE AND COMMUNICATE WITH USER GROUPS

1335 1. What Lies Beneath: Addressing Conflicts Arising From Spearfishing Activities in the Waverley LGA.
Waverley Council Case Study

Ms Emily Scott Divisional Manager, Environmental Services Waverley Council

1400 2. Community Engagement & Consultation in Cabbage Tree Bay. Manly Council Case Study

Clr. Cathy Griffin Manly Council

1425 3. Should Dogs be Allowed on Beaches? Warringah Council Case Study

Ms Liz Romer Acting Manager; Regulatory Compliance, Warringah Council

1500 4. Regulating Foreshore Boat Storage. Woollahra Council Case Study

Mr Paul Fraser Team Leader, Open Space and Recreation, Woollahra Council



1525 AFTERNOON TEA

1540 WORKSHOPS





1. "Challenges of Enforcement"
2. "Building Better Partnerships Across Agencies"
3. "Education And Outreach To User Groups"

EMERGENCY PROCEDURES

<p>IN AN EMERGENCY TELEPHONE:</p> <p>FIRE BRIGADE 000</p> <p>POLICE 000</p> <p>AMBULANCE 000</p>	<p>WHEN YOU DIAL THE EMERGENCY NUMBER:</p> <ol style="list-style-type: none"> 1. Advise location 2. Provide your name and telephone number and any other information requested by the operator. 	<p>IF YOU HEAR THE FOLLOWING ALARMS:</p> <p>ALERT  Keep Stop Stop</p> <p>ACTION: All workers to respond. Staff to check immediate area for signs of danger and stand by. (Outside normal working hours immediately evacuate on sounding of the Alert Alarm)</p> <p>EVACUATION  Whoop Whoop Whoop</p> <p>ACTION: All staff evacuate via the nearest exit and proceed to the assembly area.</p>
--	--	--

IN ALL CASES, ADVISE PROPERTY MANAGER

<p>EVACUATION PROCEDURES</p> <p> Whoop Whoop Whoop</p> <p>IF IN IMMEDIATE DANGER, or on hearing the evacuation alarm, or on being instructed to evacuate:</p> <ol style="list-style-type: none"> 1. If safe to do so secure your office and evacuate the building via the nearest exit and proceed in single file in an orderly manner to the assembly area. <p>DO NOT USE LIFTS</p> <ol style="list-style-type: none"> 2. Do not re-enter the building unless advised to do so by an authorised person. <p>N.B. OUTSIDE NORMAL WORKING HOURS EVACUATE ON SOUNDING OF THE ALERT TONE.</p>	<p>KNOW YOUR EXITS</p> <p></p> <p></p> <p>FOR YOUR SAFETY MAKE SURE YOU KNOW THE LOCATION OF THE NEAREST EMERGENCY EXIT</p>
---	---

<p>FIRE EXTINGUISHERS & HOSE REELS</p> <p>IF SAFE TO DO SO:</p> <p>FIRE EXTINGUISHERS</p> <p></p> <p>Select the correct extinguisher</p> <ol style="list-style-type: none"> 1. Remove from bracket. 2. Carry to scene of fire. 3. Whilst clear of fire remove pin and test the extinguisher. 4. Proceed to fire and initially from a distance of no closer than 2 metres direct agent at base of fire. <p>FIRE HOSE REEL</p> <p></p> <ol style="list-style-type: none"> 1. Open valve (ensure that hose reel is turned off at nozzle). 2. Run out hose toward scene of fire. 3. Open nozzle and direct stream at base of fire. <p>N.B. NOT FOR USE ON FIRES WITH AN ELECTRICAL HAZARD.</p>	<p>BOMB THREAT PROCEDURES</p> <ol style="list-style-type: none"> 1. Remain Calm. 2. Record exact wording of threat. 3. Keep the caller talking – try to obtain as much information as possible using the Bomb Threat Checklist. 4. Report call to: CHIEF WARDEN, YOUR MANAGEMENT and POLICE ON "000". 5. Record details of caller's voice and background noise. 6. Await instructions from authorised persons. 7. DO NOT HANG UP PHONE AFTER CALLER HAS FINISHED. <p>CITY OF SYDNEY City of Emergency Services</p>
---	---

city of villages

CUSTOMS HOUSE
BARNET LONG ROOM

CITY OF SYDNEY

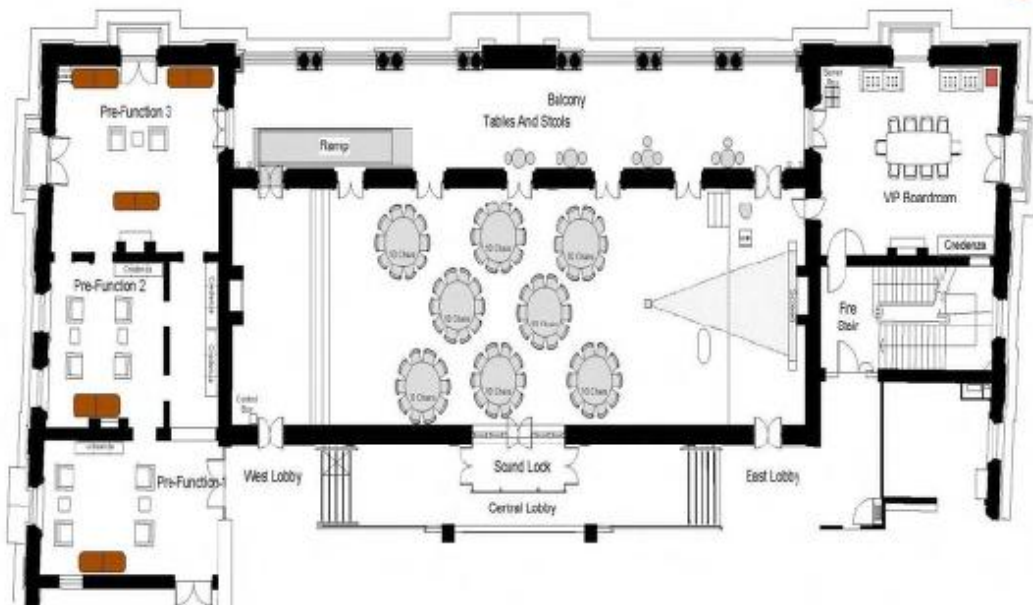
0m 2m 5m 10m



BOUNDARIES AND BARRIERS

MANAGING THE INTERTIDAL ZONE *Biographies and Synopses*

Ms Susan Hartley

Senior Assessment Officer; Performance and Compliance.

Division of Local Government

Susan has been with the Division of Local Government since 2004. As the Division's Senior Assessment Officer, Susan is responsible for the assessment of a variety of statutory applications made by councils. Before working at the Division, Susan was employed for 17 years in the local government sector, primarily in property management, risk management and governance roles.

A Local Government Perspective

Ms Hartley's presentation will provide a general overview of:

- Local Government boundaries in NSW
- the requirements of the *Local Government Act 1993*, for managing land categorised as natural area and foreshore
- the recently announced Independent Local Government Review Panel
- the upcoming review of the Local Government Act 1993.

Notes:

BOUNDARIES AND BARRIERS

MANAGING THE INTERTIDAL ZONE *Biographies and Synopses*



Mr Stephen Fenn
Manager; Stakeholder Relations. Crown Lands South
Department of Primary Industries

Stephen has worked in the area of Crown Land management for almost a decade, with experience working within the Department and the Minister's office. He is presently Manager of Stakeholder Relations in Crown Lands South, which receives land management issues from the Hawkesbury to the Victorian border. One of his roles is to facilitate positive relations with key stakeholders in Crown Land management, including local government.

Coastal Crown Land: Crown Lands Management

Crown Land management has undergone a number of changes over recent decades, both in resources, priorities and the legislative framework in which it operates.

The recent structural reform will have a major impact of the way in which Crown lands does business. The logic underpinning the reform is to streamline client transactions in one stop shop business centres, freeing up scarce resources to focus on key priorities of strategic commercial development, stakeholder relations and natural resource/compliance issues.

Today's presentation will address the principles of Crown Land management, future directions, and the role to be played by local councils in managing Crown land in Sydney.

Notes:

BOUNDARIES AND BARRIERS

MANAGING THE INTERTIDAL ZONE *Biographies and Synopses*



Mr Carlos Da Rocha
Senior Ranger
Waverley Council

Carlos is an employee of Waverley Council and community member of Matraville. Employed by Waverley for 25 years now, he has held the position of Senior Ranger for ten.

The Role of Enforcement: Challenges and Opportunities

Carlos will discuss the challenges that arise in the monitoring the foreshore, from a Council Ranger perspective.

Notes:

BOUNDARIES AND BARRIERS

MANAGING THE INTERTIDAL ZONE *Biographies and Synopses*



Dr Judy Lambert AM

Director

Community Solutions

Judy is the principal of a small consultancy business, Community Solutions that specialises in bringing together community, technical and government perspectives on sustainable management of our natural resources. Trained in environmental management, medical and social sciences and business administration, her career spans time as a research scientist, Canberra-based community sector, consultant to a former Federal Environment Minister and the past 19 years, as a consultant. After nine years as Manly Councillor, Judy became an honorary member of the Sydney Coastal Councils Group in 2008.

Working and Engaging with Community Groups

In this presentation Judy will explore briefly some of the major barriers to engaging and working effective with community groups.

Concerns about when to involve the community and why they might, or might not be involved, the additional knowledge they bring to issues and the ways in which some of these challenges can be addressed are discussed briefly. A coastal management case study is used to further explore both the barriers and possible solutions.

Notes:

BOUNDARIES AND BARRIERS

MANAGING THE INTERTIDAL ZONE *Biographies and Synopses*



Mr Chris Clarke

Supervising Fisheries Officer; Sydney North

Fisheries, NSW Department of Primary Industries

Chris Clarke has been working as a Fisheries Compliance officer in NSW for over 27 years. His work has taken him to many locations throughout the state including the South Coast, the Highlands, Far West and Sydney Regions. His Compliance role includes the management for the sustainability of the Natural Resource Fisheries and the protection of aquatic habitats. Chris represents DPI on various committees that impact on Sydney Harbor and he is the Project Manager for FO Training and assists with managing assets and communications state-wide.

Fisheries Legislation and Management in the Intertidal Zone: Implications for Council

A discussion of Fisheries legislation and management activities that relate to Sydney's intertidal zone. These include management of fishing activities, intertidal protected areas, aquatic reserves, and aquatic habitat protection and fisheries compliance activities. Implications for Councils and Fisheries NSW expectations of Councils will be discussed. Fisheries' Carla Ganassin from the Aquatic Habitat and Protection Unit and Rodney James from Aquatic Reserves Unit will assist with the presentation.

Notes:

BOUNDARIES AND BARRIERS

MANAGING THE INTERTIDAL ZONE *Biographies and Synopses*



Mr Gary Dunnett
Regional Manager; Metro North East
National Parks and Wildlife Service

Mr Gary Dunnett is the Regional Manager of Metro North East for National Parks and Wildlife Service as well as the Acting Director of Metropolitan and Mountains Branch. Gary was previously the National Parks Area Manager for Botany Bay.

Addressing the Issues of Shared Boundaries

Gary will discuss the issues (and opportunities) that arise when Councils and National Parks share property boundaries on and near intertidal areas. He will present a case study on the interaction of protected and intertidal areas in Botany Bay.

Notes:



BOUNDARIES AND BARRIERS

MANAGING THE INTERTIDAL ZONE *Biographies and Synopses*

Ms Emily Scott
Divisional Manager, Environmental Services
Waverley Council

Emily Scott graduated from Southern Cross University in 2001 with a Bachelor of Applied Science (Honours) majoring in Coastal Management. Following graduation, Emily was fortunate enough to secure an internship at Waverley Council where she commenced work as an Environment Officer. In 2002, Emily was appointed to the role of Environmental Services Manager, a position which she still holds. Working closely with Strategic Planners and Assessment staff at Waverley, Emily developed an interest in land use planning and in 2004 enrolled in a Masters of Urban Planning at the University of Technology, Sydney. She is currently finishing her Master's thesis researching future options for Municipal Solid Waste Management in Sydney.

What Lies Beneath: Addressing Conflicts Arising From Spearfishing Activities in the Waverley LGA. Waverley Council Case Study.

Every summer on the northern headland of Bondi Beach, snorkelers, swimmers, rockpool rambles and fishers come to enjoy the beautiful environment on offer within in the designated Intertidal Protected Area. However, the sharing of this relatively small area between these passive and active uses is a common source of conflict. Conflict that requires regular intervention and resolution by Council Rangers, Lifeguards and other Council staff. In 2005, Waverley Council embarked on a program to reduce these user conflicts by attempting to restrict and control spearfishing activities in North Bondi. This presentation provides an overview of the Waverley spearfishing program, the key learning from our attempts to better manage these coastal conflicts, and the importance of good consultation with all stakeholder groups in the decision making process.

Notes:

BOUNDARIES AND BARRIERS

MANAGING THE INTERTIDAL ZONE *Biographies and Synopses*



Councillor Cathy Griffin

Manly Council

A member of The Greens, Cathy Griffin is a mother of three and has been a Manly resident for 11 years. She gained wide experience in administration, logistics and facilities management from 17 years service in the Regular Army as an Officer. As Past Chair of the Little Manly Precinct Community Forum and as a member of the Manly Council Environment and Climate Change Committees, Cathy has a history of active community consultation and is the Vice-Chairperson (Ocean) of the SCCG. Participation in the North Head Sewerage Treatment Plant Community Consultative meetings as well as the Quarantine Station Community Consultative Committee also contributes to Cathy's knowledge and understanding of the community and environment in which she lives. Cathy is interested in and committed to social justice, ecological sustainability, grassroots democracy and peace; the four pillars that inform the Greens policies.

Community Engagement and Consultation in Cabbage Tree Bay. Manly Council Case Study

Councillor Griffin will discuss the community engagement process that Council undertook to collaborate with LGA residents in the conservation of Cabbage Tree Bay.

Notes:

BOUNDARIES AND BARRIERS

MANAGING THE INTERTIDAL ZONE *Biographies and Synopses*



Ms Liz Romer
Acting Manager: Regulatory Compliance
Warringah Council

Ms Romer has been at Warringah Council for the past 3 and a half years. Her substantive position involves management of companion animals in Warringah where she works closely with the rangers. Her job includes addressing issues for Council regarding dogs such as unleashed areas, impounded animals, public education and cat issues such as un-owned cats. Liz's previous jobs include 20 years of experience in zoos as well as working with NPWS and the Australian Museum.

Should Dogs be Allowed on Beaches? Warringah Council Case Study

Warringah Council has had considerable pressure over many years to provide a beach for dog unleashed exercise and swimming. Most beaches were ruled out on environmental grounds such as presence of threatened species. The most recent study was a review of Curl Curl beach as the last suitable location. The study encompassed an environmental study which found nothing of significance. The study also involved a large public consultation component. As a result the recommendations concluded that no trial of dog swimming be undertaken due to conflict with other uses as per Council's policy for dog unleashed exercise areas.

Notes:

BOUNDARIES AND BARRIERS

MANAGING THE INTERTIDAL ZONE *Biographies and Synopses*



Mr Paul Fraser
Team Leader of Open Space and Recreation Planning
Woollahra Council

Paul is employed as the Team Leader of Open Space and Recreation Planning for Woollahra Council. His role is responsible for the management of the Open Space and Recreation team playing a key role in the development of plans and policy for Council's Open Space and the management of open space.

Paul has also worked at Liverpool Council and Baulkham Hills Council in similar roles within the open space and recreation area.

Regulating Foreshore Boat Storage

Woollahra has some of the most beautiful beaches, bays and inlets in Sydney. There is approximately 16km of harbourside extending from Rushcutters Bay to Watsons Bay. Our foreshores are under high demand for a wide variety of passive and active recreational pastimes. Informal, ad-hoc and unauthorised water craft storage can be unsightly, potentially dangerous, and alienate and restrict public access to the foreshore.

Woollahra Council has implemented a *Water Craft Storage Policy* to manage the storage of water craft on public land for the benefit of boat owners and for the enjoyment of the broader community accessing the foreshore.

Notes:

BOUNDARIES AND BARRIERS MANAGING THE INTERTIDAL ZONE

Notes



BOUNDARIES AND BARRIERS MANAGING THE INTERTIDAL ZONE

Notes

